

ITEM NO.	PART NUMBER	DESCRIPTION	QTY.
1	880221	HANDLE & INSERT-LAB	1
2	672090	BUTTON COLD	1
3	672120	CIRCLIP-SPINDLE BRG	1
4	672349	ORING BS 008.5 LAB SPINDLE	1
5	672560	VALVE-JUMPER 1/2 COPPER/NITRILE	1
6	672590	WASHER - RED FIBRE 28.5 X 23 X 1.5MM SBA	1
7	892501	STUFFING BOX SHORT 1/2	1
8	880490	SPINDLE LAB	1
9	880152	DOME-LAB	1

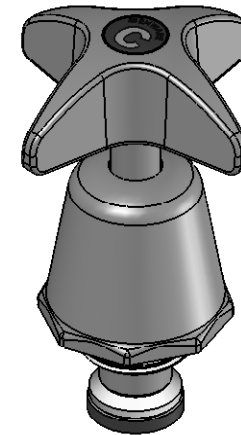

REV	DATE	CN	AMMENDMENTS	MODIFIED BY
A	14/03/06		FIRST ISSUE	
B	09/01/08		REDRAWN	SM

GENERAL NOTES:
 REMOVE ALL BURRS AND SHARP EDGES UNLESS OTHERWISE STATED
 DIMENSIONS ARE IN mm's

TOLERANCE EXCEPT WHERE STATED:

NO DECIMAL POINT ± 0.2
 ONE DECIMAL PLACE ± 0.1
 TWO DECIMAL PLACES ± 0.05
 ANGLES ± 1

ENWARE RESERVES THE RIGHT TO AMEND PRODUCT SPECIFICATIONS AND DESIGNS WITHOUT NOTICE.

DRAWN	AC	9 Endeavour Rd, Caringbah, NSW, 2229 Ph. 61-2-9525-9511 Fax. 61-2-9524-8421	
CHECKED			
APPROVED			
TITLE: VP BIB/PIL TOP ASSY			
Scale: Not To Scale		Scale: Not To Scale	
MATERIAL:			
FINISH: CHROME PLATED			
<small>This drawing is the Copyright of Enware Australia Pty Ltd and may not be reproduced in full or part without the written consent of Enware Australia Pty Ltd</small>			
DWG NO. VP390			SHEET 1 OF 1