

ITEM NO.	PART NUMBER	DESCRIPTION	QTY.
1	895506	STUFFING BOX BUBBLER (PR)	1
2	895052	BASE S/BOX BUBBLER (PR)	1
Ⓑ 3	693368	SPINDLE AND NUT CAM S/BOX BUBBLER	1
4	693452	SEAT S/BOX BUBBLER M-0013 (PR)	1
5	672060	BALL BEARING 5/16 INCH S/S GRADE316	1
6	672455	SCREW SOC. GRUB 10-24 UNC X 3/16 S/S 304	1
7	672492	SPRING-REG S/BOX FOR BUBBLER	1
8	673346	ORING OR 3 X 1 FDA APPROVED	2
9	672357	ORING 17MMODX12MMIDX2.5MM	1
10	672590	WASHER - RED FIBRE 28.5 X 23 X 1.5MM SBA	1
11	880510	SPINDLE & PIN - CAM	1
12	672120	CIRCLIP-SPINDLE BRS	1
13	880149	DOME-CAM (BUBBLER)	1
14	880221	HANDLE & INSERT-LAB	1
15	672090	BUTTON COLD	1
16	671113	CAP PT022-38W (1997 SPR ACT) (WHITE)	1

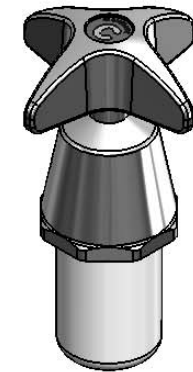

REV	DATE	CN	AMMENDMENTS	MODIFIED BY
A	12/10/06		FIRST ISSUE	
B	09/03/09		REDRAWN, 693368 REPLACE 693451 & 895312 Ⓑ	KN

**GENERAL NOTES:**  
 REMOVE ALL BURRS AND SHARP EDGES UNLESS OTHERWISE STATED  
 DIMENSIONS ARE IN mm's  
**TOLERANCE EXCEPT WHERE STATED:**  
 NO DECIMAL POINT / 0.2  
 ONE DECIMAL PLACE / 0.1  
 TWO DECIMAL PLACES / 0.05  
 ANGLES / 1  
 ENWARE RESERVES THE RIGHT TO AMEND PRODUCT SPECIFICATIONS AND DESIGNS WITHOUT NOTICE.

DRAWN		9 Endeavour Rd, Caringbah, NSW, 2229 Ph. 61-2-9525-9511 Fax. 61-2-9524-8421	
CHECKED			
APPROVED			
TITLE: <b>SPRING TOP ASSY - CAM ACTION</b>			
Scale: Not To Scale		Scale: Not To Scale	
MATERIAL:			
FINISH: CHROME PLATED			
This drawing is the Copyright of Enware Australia Pty Ltd and may not be reproduced in full or part without the written consent of Enware Australia Pty Ltd		DWG NO.	SHEET 1 OF 1
		<b>BUB261</b>	