

ITEM NO.	PART NUMBER	DESCRIPTION	QTY.
1	672416	VALVE-NON RETURN 10MM	2

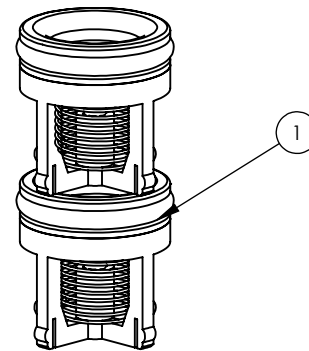

REV	DATE	CN	AMMENDMENTS	MODIFIED BY
A	11/4/12		FIRST ISSUE	

GENERAL NOTES:
 REMOVE ALL BURRS AND SHARP EDGES UNLESS OTHERWISE STATED
 DIMENSIONS ARE IN mm's

TOLERANCE EXCEPT WHERE STATED:

NO DECIMAL POINT ∕ 0.2
 ONE DECIMAL PLACE ∕ 0.1
 TWO DECIMAL PLACES ∕ 0.05
 ANGLES ∕ 1

DRAWN AC
 CHECKED -
 APPROVED -
 9 Endeavour Rd,
 Caringbah, NSW, 2229
 Ph. 61-2-9525-9511
 Fax. 61-2-9524-8421



TITLE: **DUAL CHECK VALVE TO SUIT LCN NOZZLE**

Scale: Not To Scale

MATERIAL:
 FINISH:

This drawing is the Copyright of Enware Australia Pty Ltd and may not be reproduced in full or part without the written consent of Enware Australia Pty Ltd

DWG NO. **LCN187**

SHEET 1 OF 1