

ITEM NO.	PART NUMBER	DESCRIPTION	QTY.
1	672559	VALVE-JUMPER 12MM HYDROSEAL	1
2	790503	SUB SBA HOT JHS RECESS RTC LONG	1
3	891131	CAP 2L PLASTIC RED	1

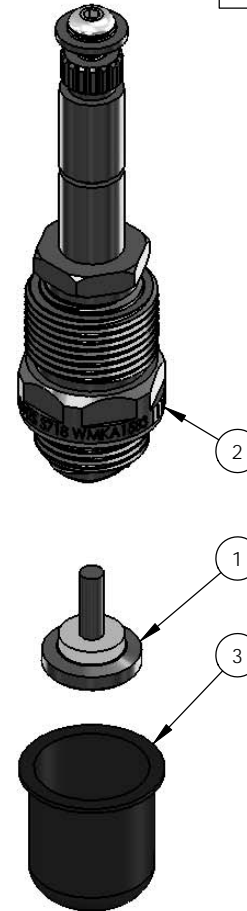
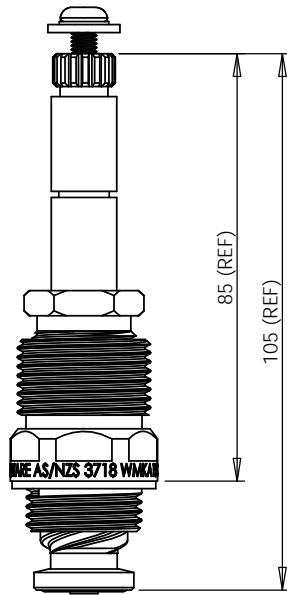
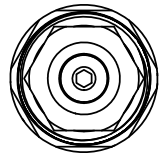

REV	DATE	CN	AMMENDMENTS	MODIFIED BY
A	10/10/07		FIRST ISSUE	

GENERAL NOTES:  
 REMOVE ALL BURRS AND SHARP EDGES UNLESS OTHERWISE STATED  
 DIMENSIONS ARE IN mm's  
 TOLERANCE EXCEPT WHERE STATED:  
 NO DECIMAL POINT  $\pm 0.2$   
 ONE DECIMAL PLACE  $\pm 0.1$   
 TWO DECIMAL PLACES  $\pm 0.05$   
 ANGLES  $\pm 1$

ENWARE RESERVES THE RIGHT TO AMEND PRODUCT SPECIFICATIONS AND DESIGNS WITHOUT NOTICE.

DRAWN	KN	9 Endeavour Rd, Caringbah, NSW, 2229 Ph. 61-2-9525-9511 Fax. 61-2-9524-8421	
CHECKED			
APPROVED			
TITLE: EXPO JHS J/VALVE RECESS SBA HOT			
Scale: Not To Scale		Scale: Not To Scale	
MATERIAL:			
FINISH:			
This drawing is the Copyright of Enware Australia Pty Ltd and may not be reproduced in full or part without the written consent of Enware Australia Pty Ltd		DWG NO. <b>FSJ396</b>	SHEET 1 OF 1