

Wall Mounted Sensor Tap - Hands-Free - Active Sense

ENM5071A

The Touch Free Wall Mounted Sensor is a wall-mounted, sensor operated, hands free tap that is installed above sinks and basins. It operates by sensing a hand in front of the sensor unit. It uses a beam of invisible Infrared light which, when reflected from hand back to the sensor, operates the unit.

FEATURES

- To turn tap on, place hand under spout in front of sensor
- To turn tap off, move hand away
- Valve stays open for 6 seconds, or as long as the hand is within sensor range
- Maximum flow time of 45 seconds* per activation reduces waste and prevents vandalism
- Stainless steel sensor plate

* Longer flow times and other program settings are available at the time of ordering. Contact Enware for more information.



Product Codes

- ENM5071A-205** Wall Mounted Sensor Tap - Active Sense system with 205mm spout
ENM5071A-250 Wall Mounted Sensor Tap - Active Sense system with 250mm spout

Technical Information

Inlet Connection	15 mm (1/2") BSP
Recommended Working Pressure	100 - 500 kPa*
Flow Rate	4 star (7.7 lpm) WELS rating supplied standard. 6 Star and 5 Star WELS ratings available on request.
Maximum Temperature	70 °C *
Operating Voltage	24V DC
Maximum Current	1A
Power Consumption	Less than 10W
Sensor Min / Max Ambient Temperature	Minimum: -5 °C, Maximum: 50 °C
Sensor Protection Rating	IP67 for the front panel and sensor lens. No IP rating behind panel.
Sensor Range	100 - 235 mm
Flow Time	Runs as long as hand is within range. (Active Sense) When out of range, runs for 6 seconds. (Afterflow) Maximum continuous flow period per sensor activation is 45 seconds. (Security Time Out)

*Enware products are to be installed in accordance with the Plumbing Code of Australia (PCA) and AS/NZS3500. Installations not complying with PCA and AS/NZS 3500 may void the product and performance warranty provisions.

Reference should also be made to the Australasian Health facility Guidelines (AHFG), ABCB and Local Government regulations when considering the choice of, and the installation of these products.

NOTE: Enware Australia advises:

1. Due to ongoing Research and Development, specifications may change without notice.
2. Component specifications may change on some export models.

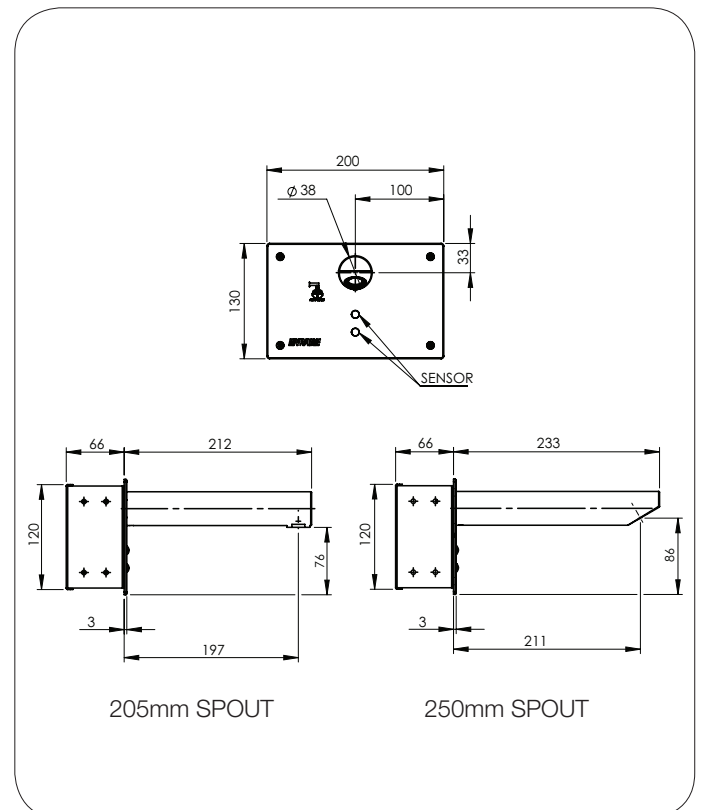

205mm SPOUT

250mm SPOUT

Version: Dec 19

Call 1300 369 273
www.enware.com.au

Enware Australia Pty Limited
 9 Endeavour Rd Caringbah NSW 2229 Australia
 Ph: 02 8536 4000 info@enware.com.au

