

Electronic Time Flow Shower Mixer

Installation Instructions

EMD815



I00224_JAN 2017

Call 1300 369 273

www.enware.com.au

Enware Australia Pty Limited

9 Endeavour Rd Caringbah NSW 2229 Australia

Ph: +61 2 8556 4000 Fax: +61 2 8556 4055

The ENWARE logo consists of three stylized blue waves to the left of the word 'ENWARE' in a bold, blue, sans-serif font.

installing**confidence**

DIMENSIONS

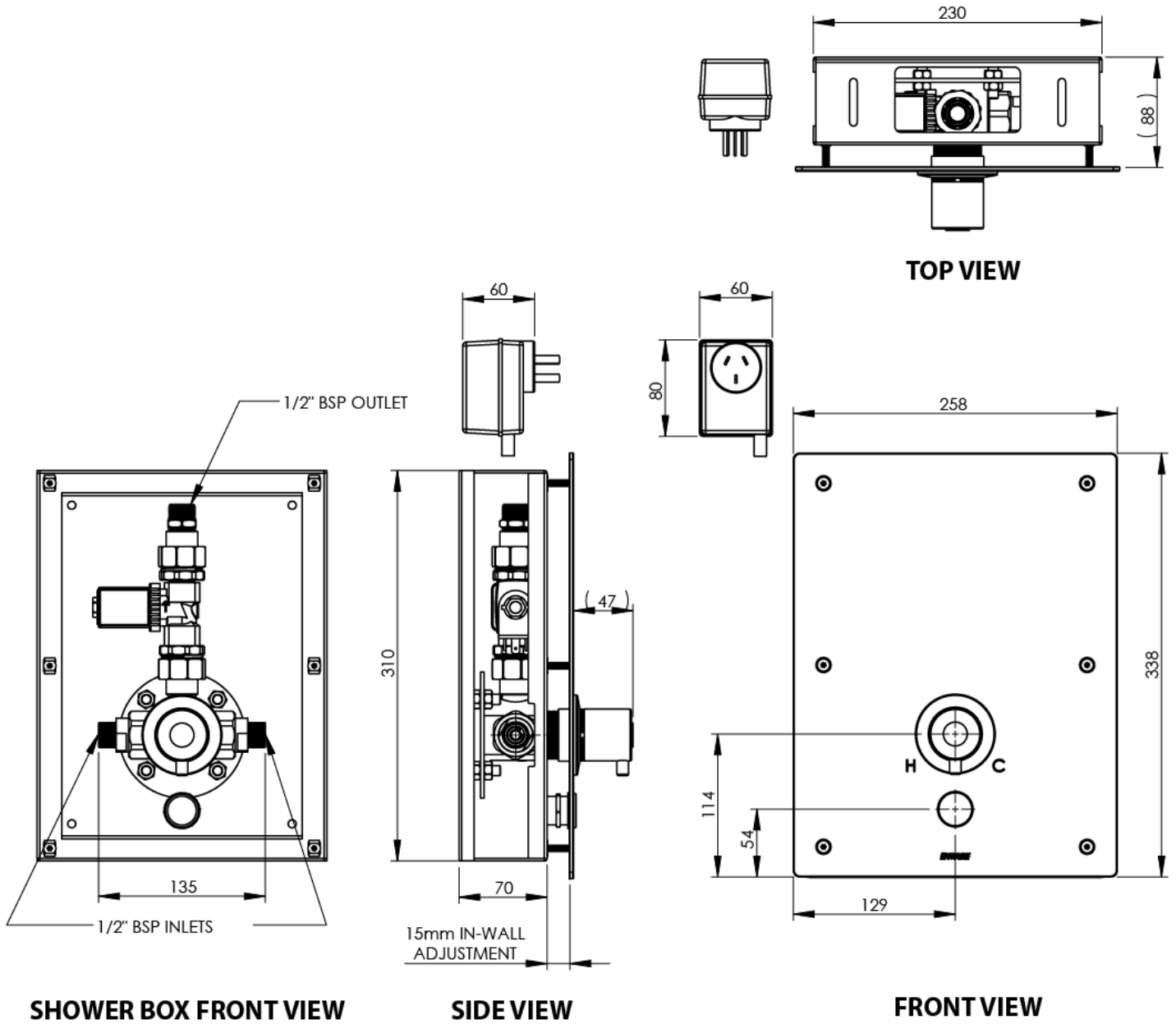

(NOT TO SCALE)

COMPONENTS

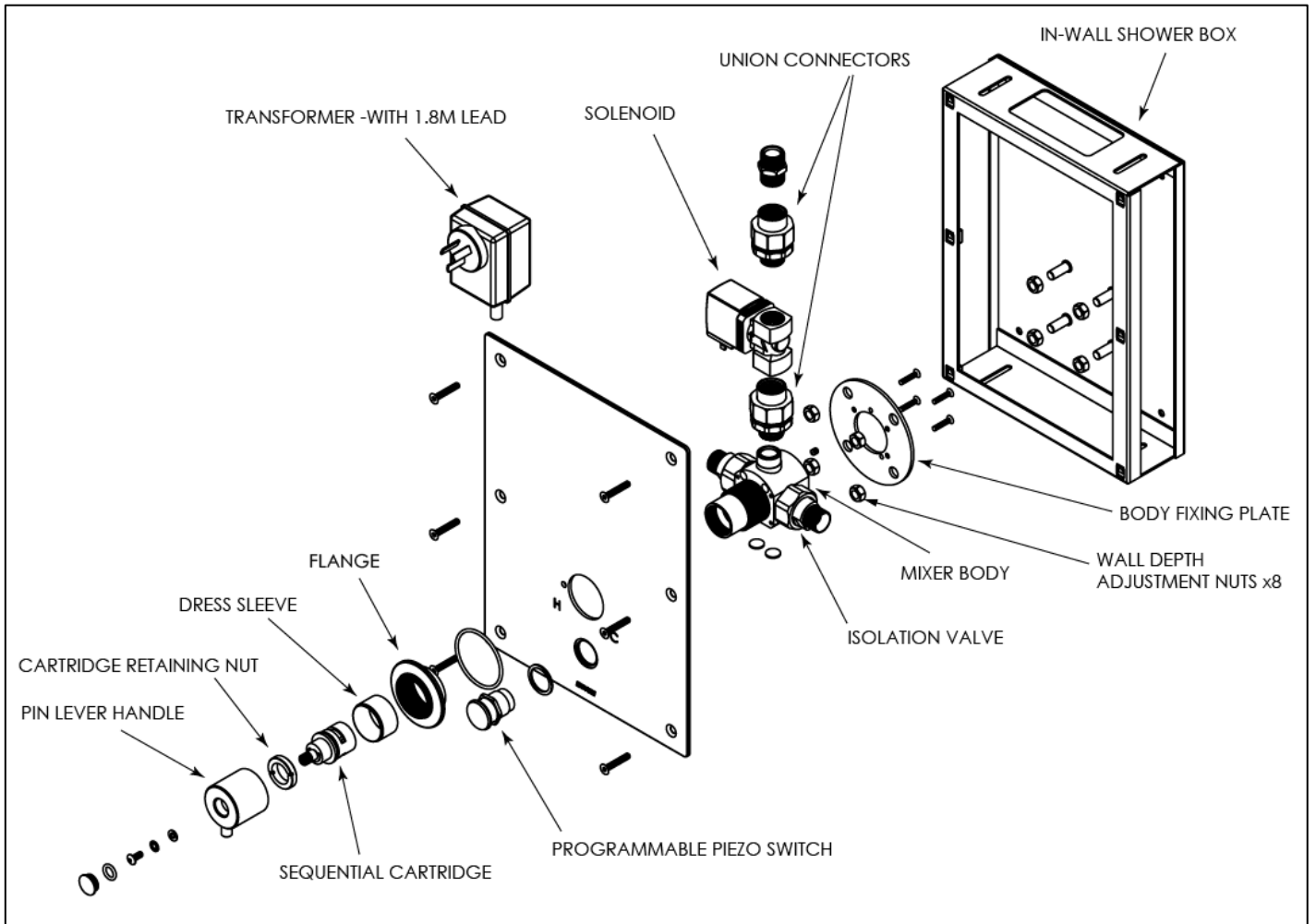

TECHNICAL TABLE

| | |
|------------------------------------|---|
| Inlet Connection | 15mm (1/2" BSP) male |
| Recommended Working Pressure Range | 50 - 500 kPa * |
| Maximum Temperature | 70°C * |
| Operating Voltage | 24V AC |
| Power Consumption | Less than 9 W |
| Power Pack | Input: 230-240 V AC 50Hz Output: 24 V AC 1.0 Amp Cable Length: 1.8 metres |
| Sensor - Touch Activated | Programmable Sensor Functions: On Time, Lockout (Off Time), Early Stop, Periodic Cycle Flush 24 hrs ON Time 3 sec – max 10 min, OFF Time 6 sec – max 10 min. (ON Time in increments of 3 sec) |
| Solenoid Valve | Brass |

For use with potable water only.

COMPLIANCE

* Enware products are to be installed in accordance with the Plumbing Code of Australia and AS/NZS3500.

Reference should also be made to the Australasian Health facility Guidelines (AHFG), ABCB and Local Government regulations when considering the choice of, and the installation of these products.

NOTE: Enware Australia advises: 1. Due to ongoing Research and Development, specifications may change without notice. 2. Component specifications may change on some export models.

This product must be installed and commissioned by a qualified plumber.

INSTALLATION - ROUGH IN

Determine Location of Shower

Wall depth: min 70mm – max 85mm from finished wall surface to the back of box.

This shower cannot be installed sideways, or upside down. The mixer body must be installed in the correct direction, with the 2 inlets on the horizontal plane. This will ensure the handle points in the correct orientation and to align with the “H” and “C” markings on the front panel.

In-Wall Body Component

1. Ensure plumbing lines are flushed prior to installation, as debris in cartridge will void warranty.
2. Remove temperature adjustment lever handle and front panel from Shower Box, taking care not to damage any cable while doing so. Disconnect spade connectors from solenoid if they are connected.
3. Secure the Shower Box to the internal cavity within the wall. The Shower Box can be fixed to a masonry wall or wall frame using screws suitable for the fixing method. (Fixing screws not supplied.)

When mounting the Shower Box, take note of the minimum and maximum wall thickness and the dimensions shown so that the nogging or recess is correctly positioned and takes into account the thickness of the finished wall.

To increase the wall depth adjustability, unscrew the four Wall Depth Adjustment Nuts, bring the position of Body Fixing Plate forward, and secure the Body Fixing Plate in place again with four nuts located behind the plate.

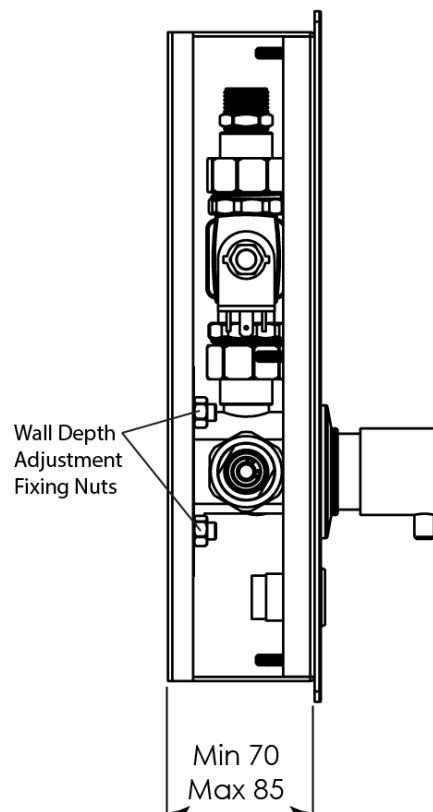

4. Purge hot and cold water lines, and connect water supply pipework to the hot and cold inlets. Connect the shower outlet to the riser leading to shower rose / outlet.
NOTE: The mixer body has 'H' and 'C' markings to indicate the appropriate supply required to each side of the mixer.

WARNING: Heat must not be applied to the inlets and outlet of the mixer as this will result in damage to the O-rings and cartridge, and void warranty.

Check valves are supplied fitted at the inlets of the mixer. However this does not qualify as a backflow prevention device. Where required, the installer must install an appropriate backflow prevention device before a shower hose according to the cross-connection hazard rating.

5. Ensure the isolation valves are closed prior to turning on Hot and Cold Water supplies. The Isolation Valve spindle has a slot which should be in a vertical position when closed. Use a 3mm Allen Key or flat head screw driver to turn the isolation valve.

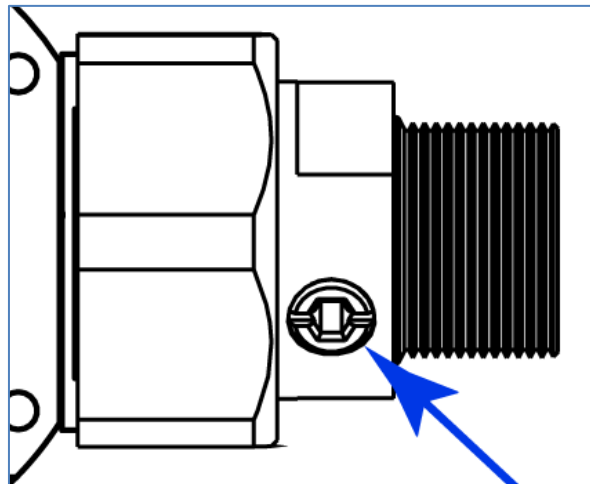

ISOLATION VALVE SPINDLE AT "ON" POSITION

6. Loosely place handle on spline of mixer cartridge.
7. Turn on Hot and Cold water supply and test for leaks within the pipework connection and Isolation Valves. Open the Hot and Cold Isolation Valves by using a 3mm Allen key or flat head screw driver and rotating the isolation spindles 90 degrees.
8. Run the cable for the power pack through a conduit, and have the connector inside shower box. Power point has to be accessible to allow for possible future replacement, repair or service.

WARNING:

**Do not cut the wires or extend existing cables without using the correct cable extension from Enware.
Cutting cables will void warranty.**

9. Connect power cable to piezo button. Connect two spade connectors to the two side connectors of the solenoid.

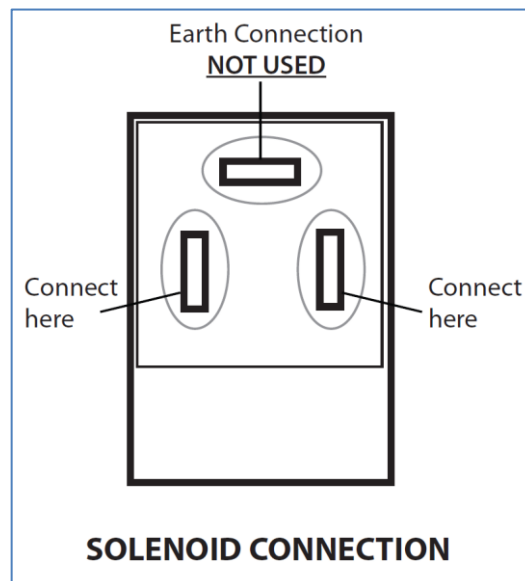
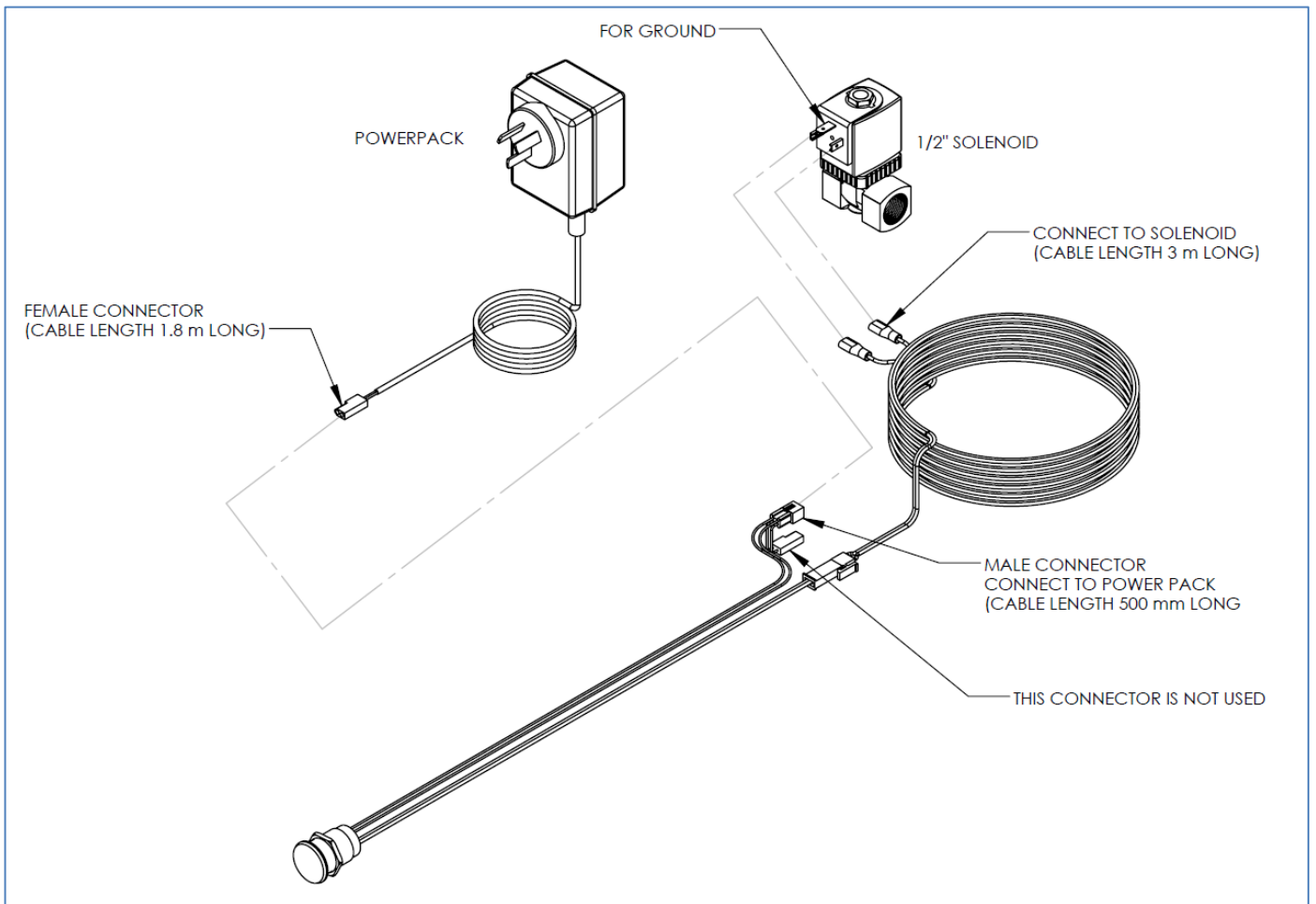

10. Turn on the power and test operation of the tap.

Note: Do not touch the piezo button for the first 10 seconds of turning the power on, otherwise the button may enter into programming mode and re-program to a different time setting.

If the piezo button needs to be re-programmed, refer to “Enware Electronic Piezo Button Program” in the following section.

Turn mixer handle and test functionality of the shower system. If there is any problem see Troubleshooting Section following or contact Enware.

11. Disconnect piezo button from power supply and solenoid. Close both the Hot and Cold isolation valves to turn off both water supplies, and keep the front panel removed until finishing trades are complete.

INSTALLATION - FIT OFF (FACIA AND HANDLE)

12. Once finished wall is complete, connect power cable to piezo cable and connect piezo to solenoid.

Note: Do not touch the piezo button for the first 10 seconds of turning the power on, otherwise the button may enter into programming mode and re-program to a different time setting.

13. Turn on hot and cold water. Operate the mixer and solenoid to ensure system is still functional.
14. Seal any gaps between the wall cut-out and the shower box, with appropriate silicone sealant.
15. Use foam seal supplied to seal between the wall surface and the back of the front plate. Run a thin bead of silicone sealant along the back top edge of the front plate. Place the Front Plate over the mixer and push firmly against the wall. Secure using the 6 Allen key fixing screws provided. Wipe off and clean any excess silicone sealant.
16. Screw on Flange over the mixer, and slide the chrome sleeve on.
17. Place handle onto the cartridge spline. Fit the handle fixing screw and tighten to secure the handle.
18. Test the operation of tap, check that the temperature settings and the orientation of mixer handle align, and adjust the position of handle if required.

OPERATING THE MIXER

- Press the electronic piezo button once to turn on water flow. Water will flow for the set time duration.
- To adjust temperature, rotate the temperature adjustment lever towards H to make it hotter, or C for cold.
- Press the electronic piezo button once to turn off water flow. (This function is only available if STOP function is set on the electronic piezo button program.)
- If any Lockout Time (or OFF Time) is set, mixer cannot be turned on for the set period of time once it is turned off.

TROUBLESHOOTING

| PROBLEM | CAUSE | RECTIFICATION |
|--|--|---|
| Tap/ Water continues to flow | Debris in solenoid valve | Take solenoid apart and clean debris from plunger or diaphragm |
| | Piezo button has ben re-programmed to a different setting | Re-program piezo button. * |
| | Solenoid diaphragm is damaged | Replace solenoid diaphragm (service kit ENMS229)** |
| Piezo button re-programs itself to a different setting | Power supply has been turned off and back on again, and user has touched the piezo | Re-program piezo button.* Check power supply, ensure there is a stable, continuous power source. |
| Tap does not activate | Power turned off | Turn power on. |
| | Power pack damaged | Replace power pack. Check power supply, protect the power pack from electrical surge. |

* For electronic piezo button program instructions, refer to “Enware Electronic Piezo Button Program” in the following section.

** For Solenoid Servicing instructions, refer to separate document “Enware EMS804 24V Solenoid Service & Maintenance Instructions_I00228”.

SPARE PARTS

| | |
|--|---|
| Solenoid 1/2" (includes 2x 1/2" nipples) | EMS804 |
| Transformer | EMDS800 |
| Extension Lead for Transformer (2m) | EMDS801 |
| Extension Lead for Solenoid (Molex Connectors) | EMFS313 (4m) EMFS314 (2m) |
| Solenoid service kit (1/2" AC) | ENMS229 |
| Electronic Touch Piezo Button (Programmable) | EMS811 (Default 6 sec ON, specify required time when ordering) |

CLEANING

Enware Product should be cleaned with a soft damp cloth using only mild liquid detergent or soap and water. Do not use cleaning agents containing a corrosive acid, scouring agent or solvent chemicals. Do not use cream cleaners, as they are abrasive. Epoxy coated surfaces should only be cleaned with a cloth and clear water or mild detergent. Use of unsuitable cleaning agents may damage the surface. Any damage caused in this way will not be covered by warranty.

Enware Electronic Piezo Touch Button Program

(24V System, From 2013 - Current)

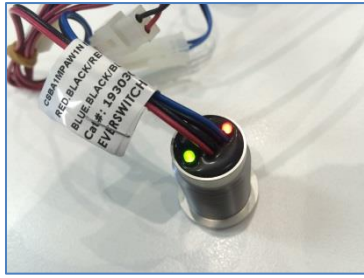

Enware Programmable Piezo Button is a touch-activated electronic switch that can be easily set to a desired timing. Its versatility allows it to be set again to a different program on site should there be any change of mind.

The electronic button timing program offers the following features:

Run Time (ON Time)

- The length of time you want the valve to turn on.
- Minimum length 3 seconds, maximum length 10 minutes.
- In increments of 3 seconds. (3, 6, 9, 12 etc)
- Factory default time is 6 seconds.

Off Time (Lockout)

- The length of time you want the valve to stay off once stopped.
- Minimum length 0 seconds, maximum length 10 minutes Off Time.
- In increments of 3 seconds (3, 6, 9, 12 etc)
- Choose "0" (zero) if you do not want any Lockout time. (i.e. allow consecutive use.)
- This function prohibits the user from turning on the valve again for the set period of time - that is, the valve is "locked out" once turned off. It is useful when you want to limit the length of a shower to a set time and prevent consecutive use, excessive use or water wastage. The Lockout time becomes effective every time the switch turns off.

Early STOP

- Once turned on, this function allows the user to stop the flow of water even if the set Run Time has not finished yet. For example, a shower is set to run for 3 minutes but user decides to turn it off at 1 minute. (Note that any lockout time still applies once it is turned off.)
- Choose "Yes" if you want this function.
- Choose "No" if you want the water to flow for the set Run Time without interruption.
- Default factory setting is "No" (without Stop).

Flush 24 hrs

- Automatically activates the valve every 24 hrs and runs for the set Run Time, particularly useful for Legionella control and reducing the risk of bacteria growth in the water supply line.
- Choose "Yes" if you want the valve to automatically turn on every 24 hrs.
- Choose "No" if you do not want this function.
- Default factory setting is "No" (without 24 hr flush).

Adjusting the Run Time – Setting a New Program on Electronic Piezo Switch

1. To set the button to a new program, firstly turn the power OFF to the button. This can be done by either turning the power OFF at the power point, or disconnecting the power connection close to the button.
2. You will need to be able to see the two LED's – green and red – located at the back of the piezo button, so the front facia panel may need to be taken off the wall to access it.
3. Connect or turn ON the power to the switch. As soon as the power is on, a 3-second programming window opens. If the switch is not pressed in this time frame, both RED and GREEN LED's flash alternately, and the switch returns to the last program it was set to.
4. Press the switch ONCE within the 3-second programming window. Red LED turns on.
5. Without delay, press the switch to select the program number. Press the switch slowly but firmly at 1-second intervals. (e.g. 4 presses to select program 4). The green LED blinks every time the switch is pressed. Valid programs are 1 to 12. Pressing the switch 13 times returns the switch to factory settings as per table.
6. Once the program No. has been selected, the RED LED will turn off and the GREEN LED will turn on. The switch is now ready to set the "ON time". Each press of the switch will increase the "ON time" by the indicated increments. e.g. If program no.4 has been selected the increments are by 3 seconds each (one press-3 sec; 2 presses-6 sec and so on), therefore pressing the switch 4 times will set the "ON time" to 12 seconds. The RED LED blinks for each press of the switch.
7. Now the "ON time" has been selected, the GREEN LED will turn off and the RED LED will turn on. The switch is now ready to set the "OFF time". Each press of the switch will cause the GREEN LED to blink, increasing the "OFF time" by the increments indicated on table. e.g. If program no.4 has been selected the increments are by 6 sec, **starting at 0 sec.** (one press – 0 sec; 2 presses – 6 sec and so on for program 4. Button has to be pressed at least once.) Refer to table.
8. Once the "OFF time" is set, the GREEN and RED LED's will blink alternately indicating that the switch is exiting the program mode.
9. Switch is now set.

PROGRAMMING TABLE

| Step 1 | | | Step 2 | | Step 3 | |
|-------------------------------|------|-----------|-----------------|----------------------|----------------|----------------------|
| Select Software Configuration | | | | | | |
| Red LED is ON | | | Green LED is ON | | Red LED is ON | |
| No. of Presses | Stop | Flush 24h | On Time(Sec) | Increment Step (Sec) | Off Time (Sec) | Increment Step (Sec) |
| 1 | No | No | 3--30 | 3 | 0-60 | 6 |
| 2 | Yes | No | 3--30 | 3 | 0-60 | 6 |
| 3 | No | Yes | 3--30 | 3 | 0-60 | 6 |
| 4 | Yes | Yes | 3--30 | 3 | 0-60 | 6 |
| 5 | No | No | 30-300 | 30 | 0-60 | 6 |
| 6 | Yes | No | 30-300 | 30 | 0-60 | 6 |
| 7 | No | Yes | 30-300 | 30 | 0-60 | 6 |
| 8 | Yes | Yes | 30-300 | 30 | 0-60 | 6 |
| 9 | No | No | 60-600 | 60 | 0-600 | 60 |
| 10 | Yes | No | 60-600 | 60 | 0-600 | 60 |
| 11 | No | Yes | 60-600 | 60 | 0-600 | 60 |
| 12 | Yes | Yes | 60-600 | 60 | 0-600 | 60 |
| 13 | Yes | No | 6 | -- | 0 | -- |

WARRANTY

Product Warranties for Australia

Effective 1 September 2014

Enware Australia Pty Limited (ACN 003 988 314) (“we” or “us”) warrants that this product (also referred to as “our goods”) will be free from all defects in materials and workmanship for 12 months* from the date of purchase. Our liability under this warranty is limited at our option to the repair or replacement of the defective product or part, the cost of repair of the defective product or part or the supply of an equivalent product or part, in each case if we are satisfied the loss or damage was due to a defect in the materials or workmanship of the product or part. All products must be installed in accordance with the manufacturer’s instructions, the PCA, and AS/NZS3500 including any other applicable regulatory requirements.

Making a claim

To make a claim under this warranty you must notify us in writing within 7 days of any alleged defect in the product coming to your attention and provide us with proof of your purchase of the product together with a completed Product ServiceRequest form (ENF091), which is available on request from our office or website (see contact details below). All notifications and accompanying forms must be sent to us marked for the attention of the Enware Australia Pty Limited, 9 Endeavour Road, Caringbah NSW 2229. We can also be contacted by telephone (1300 369 273) or by email (info@enware.com.au). Your costs in making a claim under this warranty, including all freight, collection and delivery costs, are to be borne and paid by you. We also reserve the right at our cost to inspect any alleged defect in the product wherever it is located or installed or on our premises.

Exceptions

This warranty does not apply in respect of any damage or loss due to or arising from:

- a) Failure by you or any other person to follow any instructions for use (including instructions and directions relating to the handling, storage, installation, fitting, connection, adjustment or repair of the product) published or provided by us;
- b) Failure by you or any other person responsible for the fitting, installation or other work on the product to follow or conform to applicable laws, standards and codes (including the AS/NZ 3500 set of Standards, all applicable State and Territory Plumbing Codes, the Plumbing Code of Australia and directions and requirements of local and other statutory authorities); or
- c) Any act or circumstance beyond our control including faulty installation or connection, accident, abnormal use, acts of God, damage to buildings, other structures and infrastructure and loss or damage during transit or transportation of the product.

Other conditions

Except as provided or referred to in this document, we accept no other or further liability for any damages or loss (including indirect, consequential or economic loss) and whether arising in contract, tort or otherwise. Any benefits available to you under this warranty are in addition to any non-excludable rights or remedies you may have under applicable legislation, including as a “consumer” under the Australian Consumer Law. To that extent you need to be aware that: *Our goods come with guarantees that cannot be excluded under the Australian Consumer Law. You are entitled to a replacement or refund for a major failure and for compensation for any other reasonably foreseeable loss or damage. You are also entitled to have the goods repaired or replaced if the goods fail to be of acceptable quality and the failure does not amount to a major failure.*

*12 Months parts and labour warranty on the complete assembly - Electronic Tapware.



ADDRESS: 9 Endeavour Road, Caringbah NSW 2229 Australia

POSTAL ADDRESS: P.O. Box 2545, Taren Point NSW 2229 Australia

PHONE: 61 2 8536 4000 FAX: 61 2 8556 4066

1300 369 273 (AUS) WWW.ENWARE.COM.AU INFO@ENWARE.COM.AU

ABN 23 003 988 314

