

Emergency Stainless Steel Combination Shower with Hand Operated Eye/Face Wash

ECE240

Enware's emergency safety showers assist in the rapid flushing of contaminants from the body with a deluge of flushing fluid and eye/face wash units help to flush contaminants and irritants from eyes and facial area.

Designed and manufactured in Australia. Stainless steel construction provides superior durability and reliability.

FEATURES

- Independently tested for compliance to ANSI Z358.1 and AS4775
- Freestanding for stand-alone operation
- Stainless steel pipe work & stay-open ball valve
- Stainless steel 200 mm (8") shower head assembly
- Stainless steel pull rod activated shower with high visibility yellow epoxy coating
- Push activated eye/face wash with integral auto-open dust covers
- High visibility yellow powder coated push handle
- Eye/face wash features "Vertech™ Technology" where dedicated eyewash and independently angled face wash streams deliver optimum coverage
- Zero velocity apex point provides more comfort and control for effective eye cleansing.
- Self-draining design helps reduce Legionella risk, particularly in tepid water applications
- Balanced simultaneous operation

ADDITIONAL OPTIONS:

- Foot activation kit for eye/face wash activation - ESPE027
- Audio/Visual alarms for alerts
- Flow pressure and proximity switches to activate alarms & lights
- Proximity switches an alternative to flow switches
- Thermal relief valve
- Insulation of pipe work to moderate water temperature build up
- Anti-freeze valve for cold weather climates to help prevent water freezing
- NPT flange connectors
- Custom manufacturing and design
- Signage compliant to AS1319



Product Codes

ECE240	Standard Brushed Stainless Steel Finish
ECE240GR	Green Powder Coated Finish
ECE240OR	Orange Powder Coated Finish
ECE240YE	Yellow Powder Coated Finish
ECE240WH	White Powder Coated Finish

Technical Information

Inlet Connection	25 mm (1") BSP
Water Supply Line Size	Must be hydraulically sized to meet requirements.
Minimum Performance Requirements	210 kPa Caution should be taken when pressure exceeds 550 kPa (80 psi)
Minimum Flow Requirements	Shower: 76 lpm (20 US gpm) Eye/face wash: 26 lpm (6.9 US gpm)
Waste Water Outlet Size	38 mm (1 1/2") OD
Mounting Base Plate Size	150 x 150 mm (5 9/10" x 5 9/10") with 4 Bolt Holes 11 mm (7/16")
Weight	approx. 11.7kg
Dimensions	1160 x 300 x 250 mm

Installation of emergency showers, eye and eye/face wash equipment shall be in accordance with AS/NZS4775-2007 or ANSI Standard Z358.1 - whichever is applicable to the installation. Enware Australia advises:

- Due to ongoing Research and Development, specifications may change without notice.
- Component specifications may change on some export models.

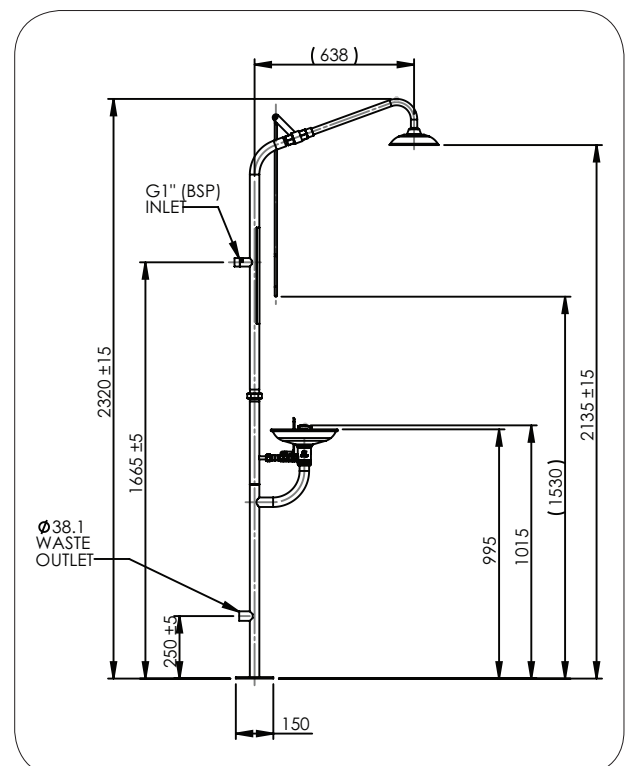

Version: Apr 18

Call 1300 369 273
www.enware.com.au

Enware Australia Pty Limited
9 Endeavour Rd Caringbah NSW 2229 Australia
Ph: 02 8536 4000 info@enware.com.au



A range of spare parts are available to maintain equipment and replacement of damaged parts.

Description	Order Code
1 Eye and Eye/Face Wash Frame Only	ESPE815
2 Push Handle to suit Eye and Eye/Face Washes	ESPE010
3 Pull handle to activate shower	ESPE009
4 Shower arm and rose	ESPE005
5 Bowl only	ESPE008
6 Foot operation conversion kit for Eye & Eye/Face Wash	ESPE001
7 Eye/Face Wash outlet includes dustcover & aerator (each)	ESPE012
8 Aerator to suit Eye/Face Wash only	ESPE013

